



VISUAL SCALE 1:100 @ A3

The new protected accessibly stair case will provide secure and safe access to the first floor gallery.

Alteration works are required to create a good access around the gallery and to accommodate the new stair.

The gallery, with the Organ removed, will benefit from increased seating in the form of extended pews.

It is proposed that the pew extensions are sympathetically created through the re-use of timber saved from the removal of the pews on the ground floor of the church.

Phase 02 Proposal

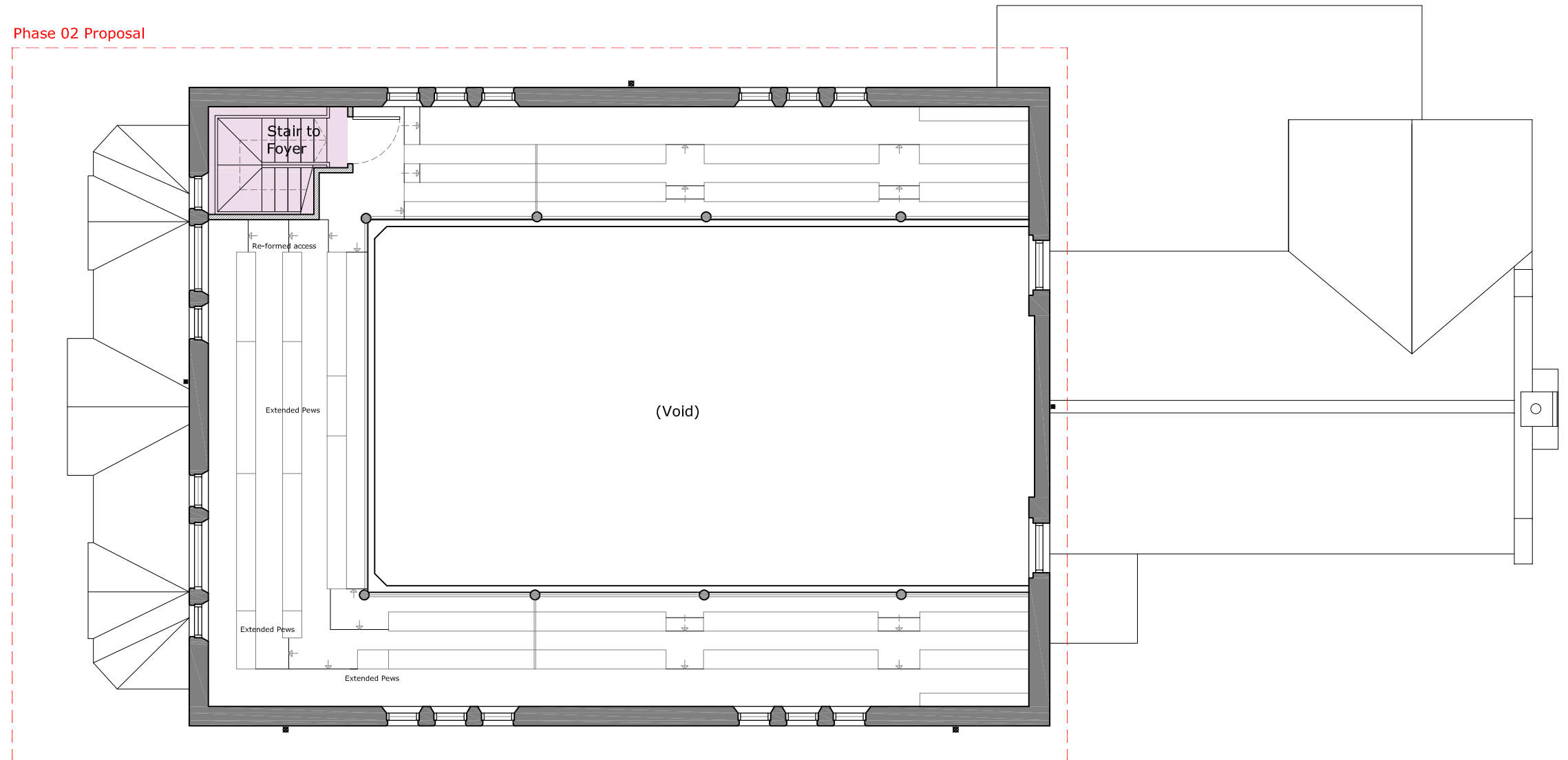

Proposed Re-ordering Works

Bluntisham Baptist Church
Sketch Proposal - First Floor
1:100 @ A3
1429-A-SK032-B